

Lift Chair

OWNER'S MANUAL



MAJUT



How to use this manual



You will receive your lift chair in excellent condition having been personally inspected before leaving the factory. By following the guidelines for maintenance your lift chair will maintain its first-class condition and give you years of complete reliability and satisfaction.

Contents

1. Introduction	4
2. Your product	5
3. Before use	6
Intended use	6
General safety instructions	6
Labels on you lift chair	7
Transport	8
Storage	8
4. Using the lift chair	9
Hand control operation	9
Entrapment zones	10
5. Installation and adjustments	11
Unboxing	11
Assembling the lift chair	11
Mounting the backrest	11
Removing the backrest	12
Mounting the wheels	12
6. Maintenance	13
Fabric care	13
Electronics care	13
Cleaning	14
Expected lifespan	14
End of use	14
7. Technical specification	15
8. Warranty	16

1. Introduction

Congratulations! You are now owner of a Majut lift chair!

This lift chair is made by qualified and committed personnel. It is designed and produced according to high quality standards.

Please read this Owner's Manual before using your lift chair for the first time. Improper use of the lift chair may result in harm or injury.

This Owner's manual is composed of the product design and specifications at the time of publication. As design's change, some illustrations and pictures in the manual may not correspond to the lift chair that you purchased. We reserve the right to make design modifications. The manufacturer disclaims all responsibilities for any personal injury or property damage that may occur as a result of improper or unsafe use of this product. Damage to the product due to improper use or lack of maintenance will void the warranty.

If you still have questions after reading this manual, do not hesitate to contact your specialist dealer. He/she will be glad to help you on this subject.



WARNING!

Indicates a potentially hazardous condition/situation. Failure to follow designated procedures can cause either personal injury, component damage or malfunction. On the product, this icon is represented as a black symbol on a yellow triangle with a black border.

2. Your Product

It provides a comfortable sitting experience and helps people standing up again by lifting and assisting.

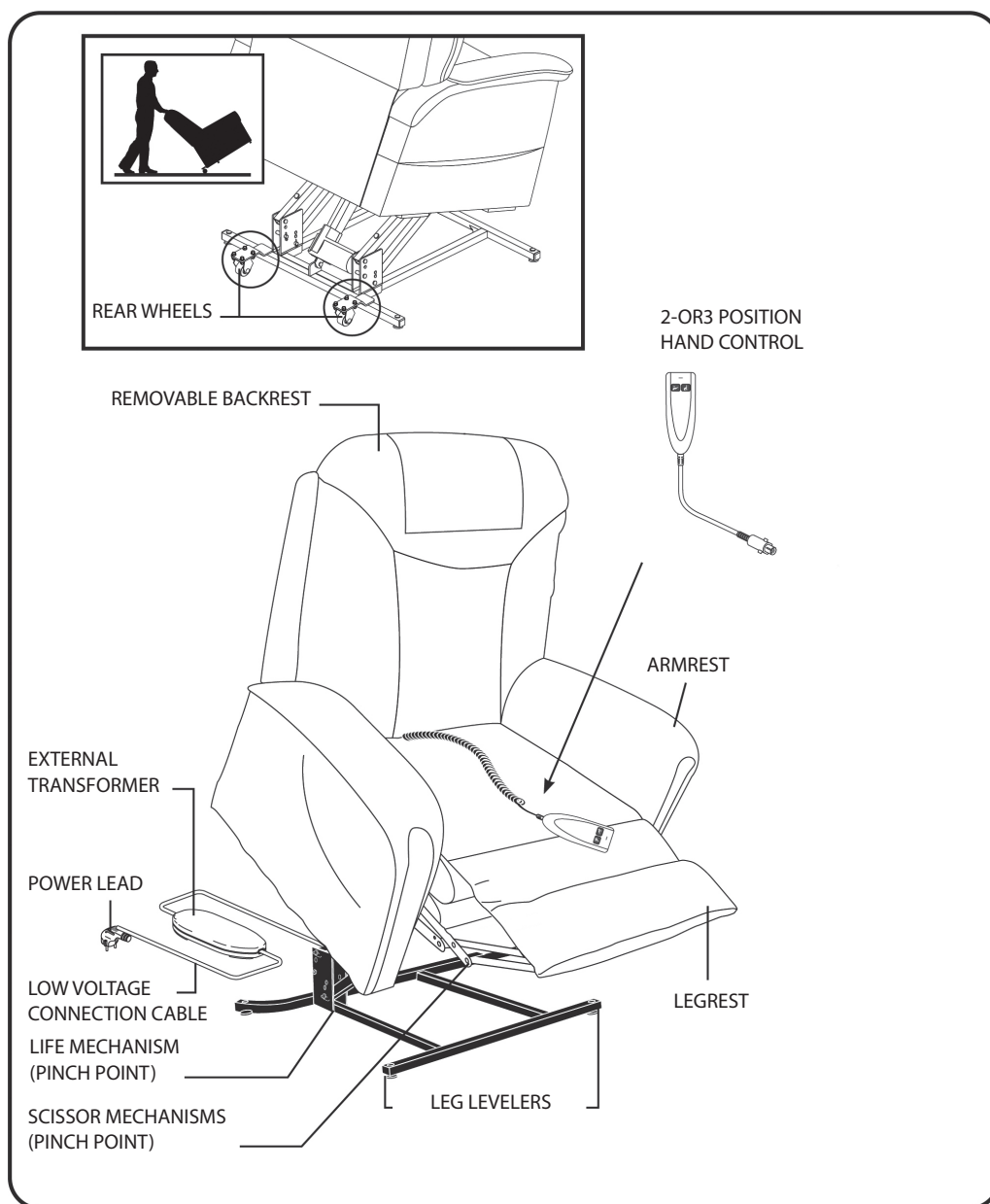

3. Before use

Intended use

- This lift chair is suitable for indoor use only.
- Your power lift chair is a state-of-the-art life-enhancement device designed to increase mobility.
- This chair lift is designed and produced to accommodate only one (1) person with a maximum weight of 115 kg.
- This lift chair is suitable for use by the elderly and people with weakened leg function.
- Use only approved accessories and spare parts.
- The warranty on this product is based on normal use and maintenance as described in this manual. Damage to your product caused by improper use or lack of maintenance will cause the warranty to lapse.

General safety instructions

Keep the following general warnings in mind during use:

- Plug the power lead directly into the electrical outlet. Do not use an extension lead.
- Keep the hand control away from all heated surfaces.
- Make sure that the lift chair is placed on even ground.
- Make sure that cables do not become entrapped.
- Keep children and pets away from all moving parts while operating the power lift chair.
- Do not sit on the backrest, armrest or legrest. Do not lean heavily on the legrest when getting into/out of the chair.
- When inclining the backrest and/or legrest, make sure that there is enough space between the chair and the wall or other object.
- Do not move the lift chair when the lift chair is in lying down position or connected to the power outlet.
- Avoid pinch points, such as the lift and scissor mechanisms. Keep hands and feet clear of these areas.

Labels on your lift chair



Pinch/Crush Points Hazard! Do not place objects or appendages in the path of moving parts.



Electrical Hazard.



Read and follow the information in the owner's manual.



Maximum weight capacity.



Do not connect an extension lead to the AC/DC converter or the battery charger.



Properly dispose of all electronic components, including the external transformer, hand control, batteries, actuator motors and wiring. Contact your authorized Dealer for more information.



Do not place objects under the power lift chair. Make sure the area is clear of obstructions, including pets and small children during operation.



Do not place objects under the footrest when the power lift chair is in the fully reclined position. Make sure area is clear of obstructions, including pets and small children during operation.



Do not cover or place the external transformer under the power lift chair. Keep in an open, well-ventilated area free from foreign material and away from possible pinch points.



Class II Equipment.

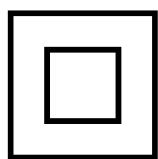

Green LED indicates power to the unit is on. Not applicable to all models.

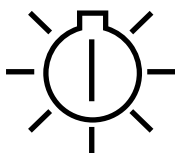

Transport

- Do not pull the backrest or armrest cushions to move your lift chair, even for a small distance, as this may cause the upholstery or stitching to tear. Instead, grasp the lower frame of the lift chair (side and bottom of the chair) to move it.
- If the lift chair will be transported in a motor vehicle, individual components and the lift chair itself should be secured against slipping.

The lift chair should only be moved when it is sitting upright. When the chair is in the lift position, the wheels will be blocked and the chair cannot be moved.

Storage

Make sure lift chair is dry to prevent mildew and damage, keep the storage temperature between +5 °C to +41 °C.

4. Using the lift chair

Certain precautions should be taken during the operation of your power lift chair. Read and follow these precautions carefully in order to ensure safe power lift chair operation and to prevent injury and/or product damage.

Hand control operation

Depending on power lift chair model, the hand control may be equipped with switches that control the movement of the chair-back, chair base and footrest.

Follow these steps to sit in your power lift chair:

Press and hold the UP button (Fig. 1) to raise your power lift chair to the standing position.

Back into the power lift chair and sit in the centre of the seat, using the armrests for support if needed.

Press and hold the DOWN button (Fig. 1) to lower the power lift chair to a comfortable seated position.

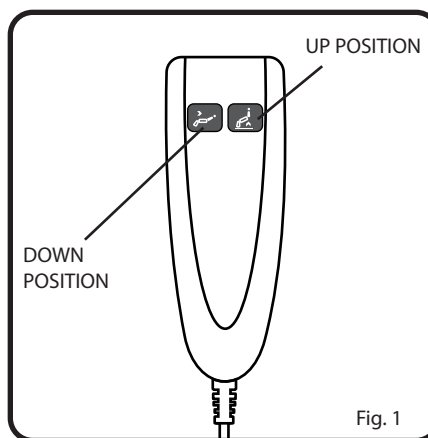

Fig. 1

Follow these steps to stand up from your power lift chair:

Press and hold the STAND button to raise your power lift chair. Release the button when the power lift chair reaches a height where you can stand up comfortably.

Entrapment zones

The picture below shows the possible entrapment zones of the lift chair. Take extra care not to get your clothes, fingers or other objects pinched between these moving parts.



5. Installation and adjustments



WARNING!

- Use only the Settings described in this manual.
- Make sure your fingers, clothing, belts, buckles or jewelry do not get caught in moving parts during assembly, use or adjustment.

Unboxing

Unpack your product and verify if the delivery is complete. The following items should be included:

- Frame with seat, armrests, legrest and lower frame
- Backrest
- Controller
- 2 wheels + 4 leg levelers
- Manual

Verify your product for transport damage. If you find any damages after delivery, contact the transporter.

Assembling the lift chair

The lift chair is delivered fully assembled with the exception of the backrest and the wheels.

Mounting the backrest

1. Place the backrest with the two sleeves (1) on the plates (2) mounted on the seat.
2. Push on the top side of the backrest until it clicks into place.
3. Make sure that the backrest is firmly fixated by pulling it slightly up again. Repeat if the backrest is loose.
4. Use Velcro strips to secure loose backrest cushions to the lower frame.

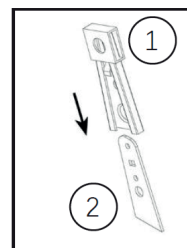

Removing the backrest

1. Loosen the backrest upholstery by pulling the Velcro strips off the lower frame.
2. Pull out the lock using a flat-head screwdriver or other tools. At the same time, pull the backrest up until both connecting plates loosen.
3. Lift the backrest from the lower frame.

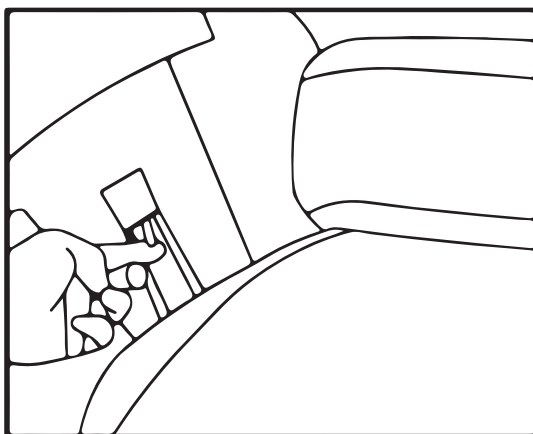

Mounting the wheels

The lift chair is delivered with a number of wheels according to your chosen version and option. To fasten the wheels into place, use the nuts (3) that are included with the delivery.

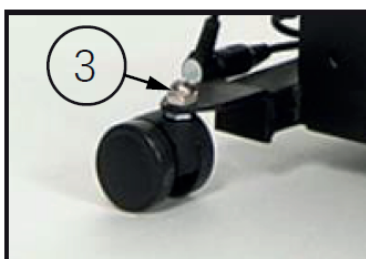

6. Maintenance

Your Power lift chair will require routine maintenance inspections. You can perform some of these checks, but others may require assistance from an authorized Dealer. Repairs and replacements may only be undertaken by trained persons and only genuine replacement parts of should be used.

By following the maintenance inspections in this section as scheduled, you can help ensure your power lift chair gives you years of trouble-free operation. If you have any questions about your power lift chair's care, contact your authorized Dealer.

Before each use, inspect the following points:

- All parts: Clean, present, and undamaged or unworn.
- Wheels, backrest: Well secured.
- General condition: No deformation, instability, weakness, or loose connections.

Contact your specialist dealer for possible repairs or part replacements.

Fabric care

- Inspect the fabric regularly for any pulls, tears or gaps.
- Frequent vacuuming and brushing lightly to remove dust and grime is the recommended cleaning method for your power lift chair.

Electronics care

- Inspect all wiring harnesses to make sure they are not damaged or frayed.
- If there is damage, please unplug the power lift chair and contact your authorized Dealer for service.
- Keep all electronic products free from extreme moisture and temperature. lift chair are intended for indoor use only.

Cleaning

Before each use, please disinfect, inspect, and maintain the lift chair according to the instructions in the maintenance manual.

Expected lifespan

The average lifespan of your lift chair is 5 years.

The life of a chair can increase or decrease depending on how often it is used and maintained.

End of use

At end of life, you need to dispose your chair according to the local environmental legislation.

The best way to do so, is to disassemble the chair to facilitate the transport of recyclable parts.

7. Technical specification

The technical details below are only valid for this chair, at standard settings and optimal ambient conditions. Take these details into account during use. The values are no longer applicable if your chair has been modified, damaged, or is severely worn.

Manufacturer	Loh Medical
Type	Lift chair
Model	Majut
Maximum occupant mass	264 lbs. 120 kg.
Description	Dimensions
Total length (Sit position)	872 mm (34.3 in)
Total Height (Sit position)	1055 mm (41.5 in)
Seat depth	480 mm (18.9 in)
Height backrest	760 mm (29.9 in)
Dismantled Height (Without backrest)	635 mm (25 in)
Height Seat (Sit position)	520 mm (20.5 in)
Dismantled depth (Without backrest)	770 mm (30.3 in)
Distance from wall	420 mm (16.5 in)
Total Width	800 mm (31.5 in)
Seat Width	550 mm (21.7 in)
Height Armrests	125 mm (4.9 in)
Total length (Recline position)	1637 mm (64.4 in)
Seat depth (Recline position)	1065 mm (41.9 in)
Total Height (Recline position)	833 mm (32.8 in)
Seat Height (Recline position)	465 mm (18.3 in)
Total length (Lift position)	862 mm (33.9 in)
Total Height (Lift position)	1390 mm (54.7 in)
Height adjustment	540 mm (21.3 in)
Height Seat (Lift position)	540 mm (21.3 in)
Backrest recline angle	147°
Footrest rise angle	86°
Chair lift angle	26°
AC/DC Adapter Inp	Input: 100-240V- , 50/ 60Hz, 1-3A: Output: DC29V, 1.8A
Degree of protection actuator	IP20
Power rating, Duty cycle actuator	DC24V, Max. 10%, max 2 min/18 min
Degree of protection manual control	IP20
EMC compliance	EN IEC 61000-3-2:2019
Storage and use temperature	+5 °C to +41 °C
Operating temperature of the electronics	-10 °C to +40 °C
Storage and use humidity	30% to 70%
We reserve the right to introduce technical changes. Measurement tolerance ± 15 mm / 1,5 kg. / 1,5° .	

8. Warranty

Loh Medical warrants the wood frame and electrical parts for a period of one year from the date of original purchase.

Labor to replace these parts is not covered.

Loh Medical shall not be responsible or obligated to pay for any costs or expenses for examination, shipping or handling of any warranted parts.

Abuse, exceeding the weight capacity, improper service by the consumer or altering by unauthorized representatives will void the warranty.